

Property Record Card

Eagle County

**POURAN ALIZADEH
IRREVOCABLE TRUST**

16735 WILLS TRCE
CHESTERFIELD, MO 63005-6555

Account: R052949

Tax Area: SC202 - VAIL (TOWN) &
LIONSHEAD TIF - SC202

Acres: 0.025

Parcel: 2101-072-06-092

Situs Address:
000680 LIONSHEAD PL #519
VAIL AREA, 0

Value Summary

Value By:	Market	Override
Condo (1)	\$2,070,040	N/A
Land (1)	\$0	N/A
Extra Feature (1)	\$3,810	N/A
Extra Feature (2)	\$3,550	N/A
Total	\$2,077,400	\$2,077,400

Legal Description

Subdivision: ANTLERS CONDOMINIUMS Unit: 519



Public Remarks

Entry Date	Model	Remark
	Condo Occurrence 1	

Sale Data

Doc. #	Sale Date	Deed Type	Validity	Verified	Sale Price	Ratio	Adj. Price	Ratio	Time Adj. Price	Ratio
200814785	06/12/2008	WD	QV	Y	\$2,200,000	94.43	\$2,150,000	96.62	\$2,150,000	96.62
796045	05/14/2002	WD	QV	Y	\$1,530,000	135.78	\$1,530,000	135.78	\$3,672,306	56.57
786710	02/13/2002	WD	QV	Y	\$1,199,000	173.26	\$1,199,000	173.26	\$2,965,846	70.04

Condo Occurrence 1

Abstract Code	1230 - CONDOS-IMPROVEMENTS	Percentage	100
Use Code	1000 - RESIDENTIAL	Neighborhood	4006.01 - ANTLERS - NEW
Building Type	123000 - CONDOMINIUM	Arch Style	26 - CONDO
Exterior Wall	23 - REINF CONC	Percentage	50.0

Property Record Card

Eagle County

Condo Occurrence 1

Roof Cover	14 - WD SID AVE	Roof Structure	50.0
Interior Wall	9 - CEDAR SHAK	Percentage	3 - GABLE/HIP
Floor	5 - DRYWALL	Percentage	100.0
Heating Fuel	14 - CARPET INV	Percentage	80.0
Air Conditioning	23 - TILE	Heating Type	20.0
Bedrooms	3 - GAS	Actual Year Built	13 - BASEBOARD
Construction Quality	0 - NONE	Bathrooms	2001
Fixtures	4	Effective Year Built	4.5
Units	5 - GOOD	Rooms	2001
Super Neighborhood	19	Units	7
Use Code	1	Stories	1
	4225 - LIONSHEAD-CASCADE CONDO & TH		1 - STORIES 1
	1000 - RESIDENTIAL		

SubArea	ACTUAL	EFFECTIVE	HEATED	FOOTPRINT
WDD	183.9			
FUS	765.7	765.7	765.7	765.7
BAS	1047.6	1047.6	1047.6	1047.6
Total	1,997.20	1,813.30	1,813.30	1,813.30
	Value	Rate	Rate	Rate
	\$2,070,040	1,036.47	1,141.59	1,141.59

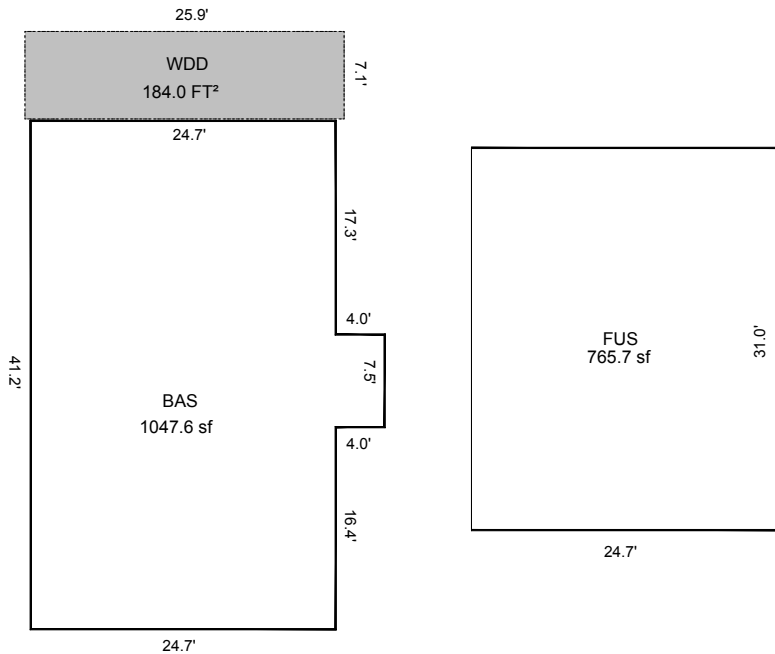

Sketch by Apex IV™

Land Occurrence 1

Abstract Code	1130 - CONDO-LAND	Percentage	100.0
Use Code	1000 - RESIDENTIAL	Neighborhood	4006.01 - ANTLERS - NEW
Land Code	11307671 - ANTLERS COND	Super Neighborhood	4225 - LIONSHEAD CASCADE CONDO & TH
Size	0.025	Zoning	6 - CONDO

Property Record Card

Eagle County

Land Occurrence 1

SubArea	ACTUAL	EFFECTIVE	HEATED	FOOTPRINT
Land S	1099			
Total	1,099.00			
	Value	Rate	Rate	Rate
	\$0			

Extra Feature Occurrence 1

XFOB Code	120 - FIREPL. G.	Abstract Code	1230 - CONDOS-IMPROVEMENTS
Percentage	100.0	Use Code	1000 - RESIDENTIAL
Neighborhood	4006.01 - ANTLERS - NEW		

SubArea	ACTUAL	EFFECTIVE	HEATED	FOOTPRINT
XFOB Units	1			
Total	1.00			
	Value	Rate	Rate	Rate
	\$3,810	3,810.00		

Extra Feature Occurrence 2

XFOB Code	340 - HYDR-TUB G	Abstract Code	1230 - CONDOS-IMPROVEMENTS
Percentage	100.0	Use Code	1000 - RESIDENTIAL
Neighborhood	4006.01 - ANTLERS - NEW		

SubArea	ACTUAL	EFFECTIVE	HEATED	FOOTPRINT
XFOB Units	1			
Total	1.00			
	Value	Rate	Rate	Rate
	\$3,550	3,550.00		

Abstract Summary

Code	Classification	Actual Value	Taxable Value	Actual Override	Taxable Override
1130	CONDO-LAND	\$0	\$0	NA	NA
1230	CONDOS-IMPROVEMENTS	\$2,077,400	\$165,360	NA	NA
Total		\$2,077,400	\$165,360	NA	NA