

Property Record Card

Eagle County

AVESA LLC

20 CEDAR ST STE 108
NEW ROCHELLE, NY 10801-5248

Account: R064613

Tax Area: SC202 - VAIL (TOWN) &
LIONSHEAD TIF - SC202

Acres: 0.013

Parcel: 2101-072-23-019

Situs Address:
000728 W LIONSHEAD CIR #R-111
VAIL AREA, 0

Value Summary

Value By:	Market	Override
Condo (1)	\$2,406,530	N/A
Land (1)	\$0	N/A
Extra Feature (1)	\$4,210	N/A
Extra Feature (2)	\$4,210	N/A
Total	\$2,414,950	\$2,414,950

Legal Description

Subdivision: WDL VAIL CONDOMINIUM Unit: R-111



Sale Data

Doc. #	Sale Date	Deed Type	Validity	Verified	Sale Price	Ratio	Adj. Price	Ratio	Time Adj. Price	Ratio
201716442	08/24/2017	WD	QV	Y	\$2,350,000	102.76	\$2,340,000	103.20	\$2,340,000	103.20
201100638	01/10/2011	SWD	UV	Y	\$2,025,000	119.26	\$1,630,000	148.16	\$1,630,000	148.16

Condo Occurrence 1

Abstract Code	1230 - CONDOS-IMPROVEMENTS	Percentage	100
Use Code	1000 - RESIDENTIAL	Neighborhood	42039 - WDL VAIL CONDOS (AKA RITZ)
Building Type	123000 - CONDOMINIUM	Arch Style	26 - CONDO
Exterior Wall	16 - FRM STUCCO	Percentage	100
Roof Cover	6 - ASP SHGL	Roof Structure	3 - GABLE/HIP
Interior Wall	5 - DRYWALL	Percentage	100
Floor	12 - HARDWOOD	Percentage	100
Heating Fuel	3 - GAS	Heating Type	3 - FORCED AIR
Actual Year Built	2010	Bedrooms	2

Property Record Card

Eagle County

Condo Occurrence 1

Bathrooms	3	Construction Quality	7 - EXCELLENT
Effective Year Built	2010	Fixtures	9
Rooms	6	Units	1
Units	1	Super Neighborhood	4225 - LIONSHEAD-CASCADE CONDO & TH
Stories	1 - STORIES 1	Use Code	1000 - RESIDENTIAL

SubArea	ACTUAL	EFFECTIVE	HEATED	FOOTPRINT
BAS	1391.9	1391.9	1391.9	1391.9
PTO	475.1			475.1
Total	1,867.00	1,391.90	1,391.90	1,867.00
	Value	Rate	Rate	Rate
	\$2,406,530	1,288.98	1,728.95	1,288.98

1ST FLOOR LEVEL

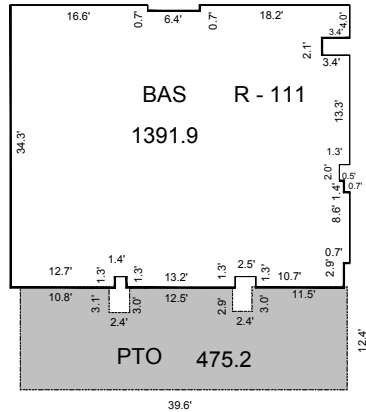

Sketch by Apex IV™

Land Occurrence 1

Abstract Code	1130 - CONDO-LAND	Percentage	100.0
Use Code	1000 - RESIDENTIAL	Neighborhood	42039 - WDL VAIL CONDOS (AK RITZ)
Land Code	11302135 - WDL VAIL CONDOS (AKA RITZ)	Super Neighborhood	4225 - LIONSHEAD CASCADE CONDO & TH
Size	0.013	Zoning	6 - CONDO

SubArea	ACTUAL	EFFECTIVE	HEATED	FOOTPRINT
Land A	0.013			
Total	0.013			
	Value	Rate	Rate	Rate
	\$0			

Property Record Card

Eagle County

Extra Feature Occurrence 1

XFOB Code	120 - FIREPL. G.	Abstract Code	1230 - CONDOS-IMPROVEMENTS
Percentage	100	Use Code	1000 - RESIDENTIAL
Neighborhood	42039 - WDL VAIL CONDOS (AKA RITZ)		

SubArea	ACTUAL	EFFECTIVE	HEATED	FOOTPRINT
XFOB Units	1			
Total	1.00			
	Value	Rate	Rate	Rate
	\$4,210	4,210.00		

Extra Feature Occurrence 2

XFOB Code	410 - STEAM SH G	Abstract Code	1230 - CONDOS-IMPROVEMENTS
Percentage	100	Use Code	1000 - RESIDENTIAL
Neighborhood	42039 - WDL VAIL CONDOS (AKA RITZ)		

SubArea	ACTUAL	EFFECTIVE	HEATED	FOOTPRINT
XFOB Units	1			
Total	1.00			
	Value	Rate	Rate	Rate
	\$4,210	4,210.00		

Abstract Summary

Code	Classification	Actual Value	Taxable Value	Actual Override	Taxable Override
1130	CONDO-LAND	\$0	\$0	NA	NA
1230	CONDOS-IMPROVEMENTS	\$2,414,950	\$173,880	NA	NA
Total		\$2,414,950	\$173,880	NA	NA