

# Property Record Card

Eagle County

**LODGE AT LIONSHEAD  
103 LLC**

380 E LIONSHEAD CIR  
VAIL, CO 81657-5263

**Account: R010442**

Tax Area: SC103 - VAIL (TOWN) -  
SC103

Acres: 0.034

**Parcel: 2101-064-05-003**

Situs Address:  
000390 E LIONSHEAD CIR #103  
VAIL AREA, 0

## Value Summary

| Value By:         | Market             | Override           |
|-------------------|--------------------|--------------------|
| Condo (1)         | \$1,741,930        | N/A                |
| Land (1)          | \$0                | N/A                |
| Extra Feature (1) | \$3,070            | N/A                |
| <b>Total</b>      | <b>\$1,745,000</b> | <b>\$1,745,000</b> |

## Legal Description

Subdivision: VAIL LIONSHEAD CONDO Unit: 103 AKA THE  
LODGE AT LIONSHEAD I



## Public Remarks

| Entry Date | Model              | Remark  |
|------------|--------------------|---|
| 07/07/2015 |                    | AMENDED DECLARATION 201509766 CHANGES THE NAME OF THE COMMUNITY AND ASSOCIATION TO THE LODGE AT LIONSHEAD I |
|            | Condo Occurrence 1 |   |

## Sale Data

| Doc. #    | Sale Date  | Deed Type | Validity | Verified | Sale Price  | Ratio  | Adj. Price  | Ratio  | Time Adj. Price | Ratio     |
|-----------|------------|-----------|----------|----------|-------------|--------|-------------|--------|-----------------|-----------|
| 201223392 | 11/20/2012 | WD        | QV       | Y        | \$1,535,000 | 113.68 | \$1,530,000 | 114.05 | \$1,791,630     | 97.40     |
| 200611747 | 04/24/2006 | WD        | QV       | Y        | \$1,375,000 | 126.91 | \$1,370,000 | 127.37 | \$1,370,000     | 127.37    |
| R721003   | 12/30/1999 | WD        | UI       | Y        | \$236,500   | 737.84 | \$236,500   | 737.84 | \$1,182         | 147631.13 |
| R713021   | 10/13/1999 | WD        | UI       | Y        | \$230,000   | 758.70 | \$230,000   | 758.70 | \$1,150         | 151739.13 |

## Condo Occurrence 1

|               |                            |              |                             |
|---------------|----------------------------|--------------|-----------------------------|
| Abstract Code | 1230 - CONDOS-IMPROVEMENTS | Percentage   | 100                         |
| Use Code      | 1000 - RESIDENTIAL         | Neighborhood | 4180 - VAIL LIONSHEAD COND. |

# Property Record Card

Eagle County

## Condo Occurrence 1

|                      |  |                      |                |
|----------------------|--|----------------------|----------------|
| Building Type        | 123000 - CONDOMINIUM                                 | Arch Style           | 26 - CONDO     |
| Exterior Wall        | 16 - FRM STUCCO<br>31 - STONE VEN<br>14 - WD SID AVE | Percentage           | 60<br>30<br>10 |
| Roof Cover           | 16 - PROPANEL  | Roof Structure       | 3 - GABLE/HIP  |
| Interior Wall        | 5 - DRYWALL  | Percentage           | 100.0          |
| Floor                | 8 - RESILIENT<br>14 - CARPET INV                     | Percentage           | 20.0<br>80.0   |
| Heating Fuel         | 3 - GAS  | Heating Type         | 13 - BASEBOARD |
| Air Conditioning     | 1 - NONE   | Actual Year Built    | 1970           |
| Bedrooms             | 2  | Bathrooms            | 2              |
| Construction Quality | 5 - GOOD   | Effective Year Built | 2000           |
| Fixtures             | 8  | Rooms                | 4              |
| Units                | 1  | Units                | 1              |
| Super Neighborhood   | 4225 - LIONSHEAD-CASCADE CONDO & TH                  | Stories              | 1 - STORIES 1  |
| Use Code             | 1000 - RESIDENTIAL                                   |                      |                |

| SubArea | ACTUAL       | EFFECTIVE   | HEATED      | FOOTPRINT   |
|---------|--------------|-------------|-------------|-------------|
| BAS     | 1298.8       | 1298.8      | 1298.8      | 1298.8      |
| PTO     | 162.4        |             |             | 162.4       |
| Total   | 1,461.20     | 1,298.80    | 1,298.80    | 1,461.20    |
|         | <b>Value</b> | <b>Rate</b> | <b>Rate</b> | <b>Rate</b> |
|         | \$1,741,930  | 1,192.12    | 1,341.18    | 1,192.12    |

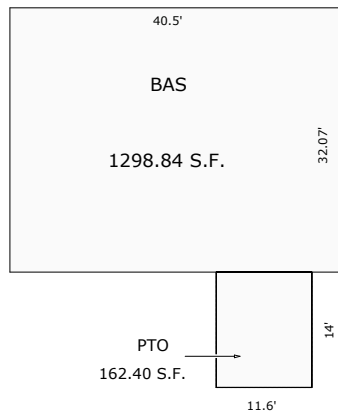

Sketch by Apex Medina™

## Land Occurrence 1

|               |                                |                    |                                |
|---------------|--------------------------------|--------------------|--------------------------------|
| Abstract Code | 1130 - CONDO-LAND              | Percentage         | 100.0                          |
| Use Code      | 1000 - RESIDENTIAL             | Neighborhood       | 4180 - VAIL LIONSHEAD COND.    |
| Land Code     | 11308573 - VAIL LIONSHEAD COND | Super Neighborhood | 4225 - LIONSHEAD CASCADE CONDO |

# Property Record Card

Eagle County

## Land Occurrence 1

---

|                |              |               |                   |               |                  |
|----------------|--------------|---------------|-------------------|---------------|------------------|
| Size           | 0.034        | Zoning        | & TH<br>6 - CONDO |               |                  |
| <b>SubArea</b> |              | <b>ACTUAL</b> | <b>EFFECTIVE</b>  | <b>HEATED</b> | <b>FOOTPRINT</b> |
| Land S         |              | 1460          |                   |               |                  |
| Total          |              | 1,460.00      |                   |               |                  |
|                | <b>Value</b> | <b>Rate</b>   | <b>Rate</b>       | <b>Rate</b>   | <b>Rate</b>      |
|                | \$0          |               |                   |               |                  |

## Extra Feature Occurrence 1

---

|                |                             |                 |                            |               |                  |
|----------------|-----------------------------|-----------------|----------------------------|---------------|------------------|
| XFOB Code      | 110 - FIREPL. A.            | Abstract Code   | 1230 - CONDOS-IMPROVEMENTS |               |                  |
| Percentage     | 100.0                       | Use Code        | 1000 - RESIDENTIAL         |               |                  |
| Neighborhood   | 4180 - VAIL LIONSHEAD COND. | Building Number | 0                          |               |                  |
| <b>SubArea</b> |                             | <b>ACTUAL</b>   | <b>EFFECTIVE</b>           | <b>HEATED</b> | <b>FOOTPRINT</b> |
| XFOB Units     |                             | 1               |                            |               |                  |
| Total          |                             | 1.00            |                            |               |                  |
|                | <b>Value</b>                | <b>Rate</b>     | <b>Rate</b>                | <b>Rate</b>   | <b>Rate</b>      |
|                | \$3,070                     | 3,070.00        |                            |               |                  |

## Abstract Summary

---

| <b>Code</b>  | <b>Classification</b> | <b>Actual Value</b> | <b>Taxable Value</b> | <b>Actual Override</b> | <b>Taxable Override</b> |
|--------------|-----------------------|---------------------|----------------------|------------------------|-------------------------|
| 1130         | CONDO-LAND            | \$0                 | \$0                  | NA                     | NA                      |
| 1230         | CONDOS-IMPROVEMENTS   | \$1,745,000         | \$125,640            | NA                     | NA                      |
| <b>Total</b> |                       | <b>\$1,745,000</b>  | <b>\$125,640</b>     | <b>NA</b>              | <b>NA</b>               |